

doors

WOSHBOX mobile toilet doors are constructed for a robust quality feel. The inward opening doors are triple hinged into rigid aluminium frames ensuring solidity and good action.

modular design

All WOSHBOX mobile toilet elements are pre-tooled to interlock with one-another. This modularity increases spares availability.

materials

Complex moulded Glass Reinforced Polyester (GRP) and Composites allow for durable, lightweight, waterproof components to be manufactured with a smooth high quality finish. Because of the good thermal qualities of GRP, the WOSHBOX stays cool in hot conditions and requires minimal energy to heat when operating in cold conditions.

easy cleaning

WOSHBOX has smooth waterproof surfaces inside and out which allows for easy cleaning with a high-pressure washer.

stairs

The folding stairs easily adjust to suit uneven terrain. Stair sets are constructed with galvanized steel. Stainless construction is available on request.

trailer

The WOSHBOX mobile toilet trailer design is unique, providing an exceptionally low centre of gravity and safe easy towing characteristics. The axle and braking system is EU TUV homologated.

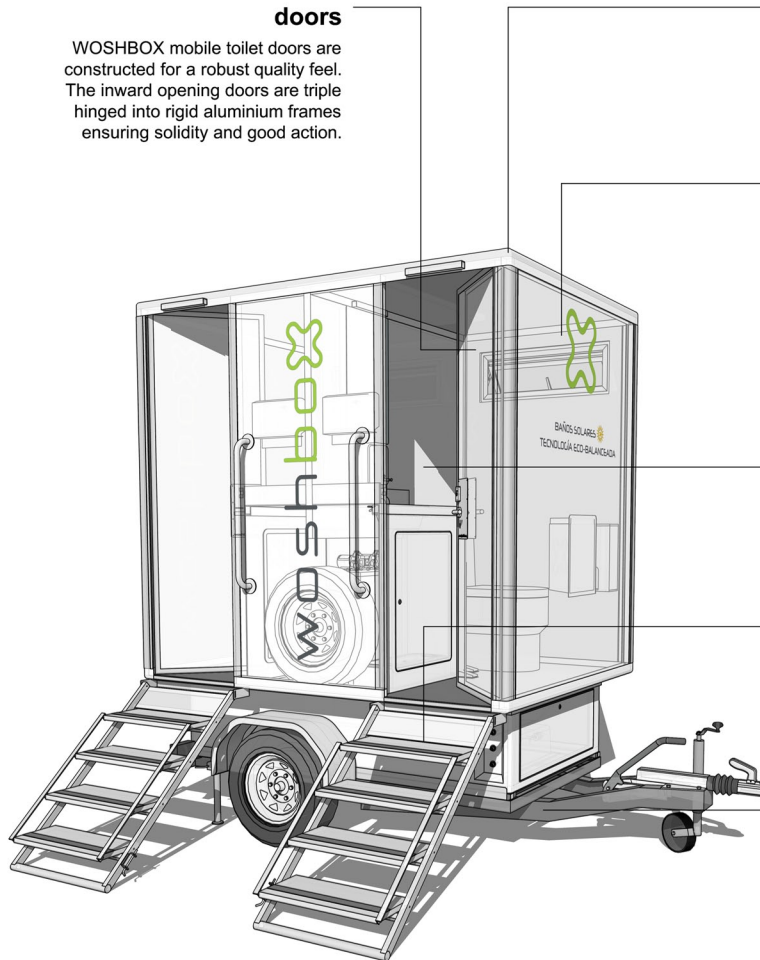

solar power

WOSHBOX is designed to be perpetually solar-powered in most climatic conditions, providing reliable performance even under heavy usage. The charge state of batteries is optimised by an 80w polycrystalline solar panel and 6 amp Steca regulator. This feature keeps the batteries constantly charged and with proper care and maintenance they can last up to 10 years.

lighting

WOSHBOX is lit by 2 interior and 2 exterior arrays of LEDs totaling 100 milli-amps. Good lighting and clear white surfaces reduce careless treatment of the toilet units. Blue and Pink LED's indicate male and female toilets and create an exceptional effect at night.

batteries

Each WOSHBOX unit uses one Delttec lead acid 102 Amp/Hr high cycle battery optimised for solar power.

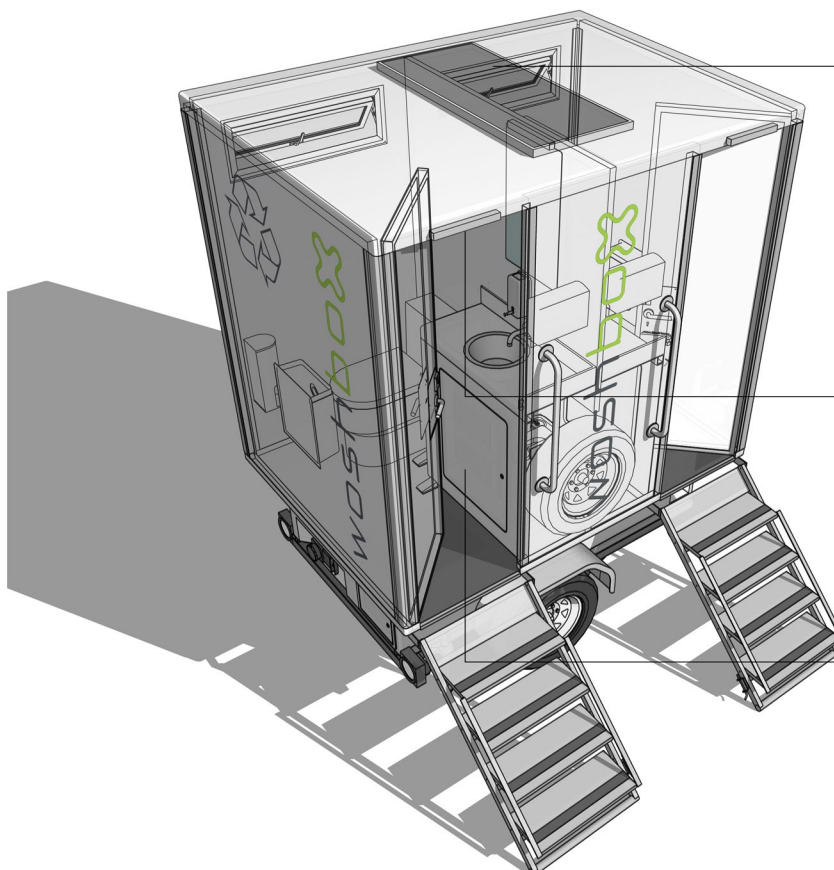

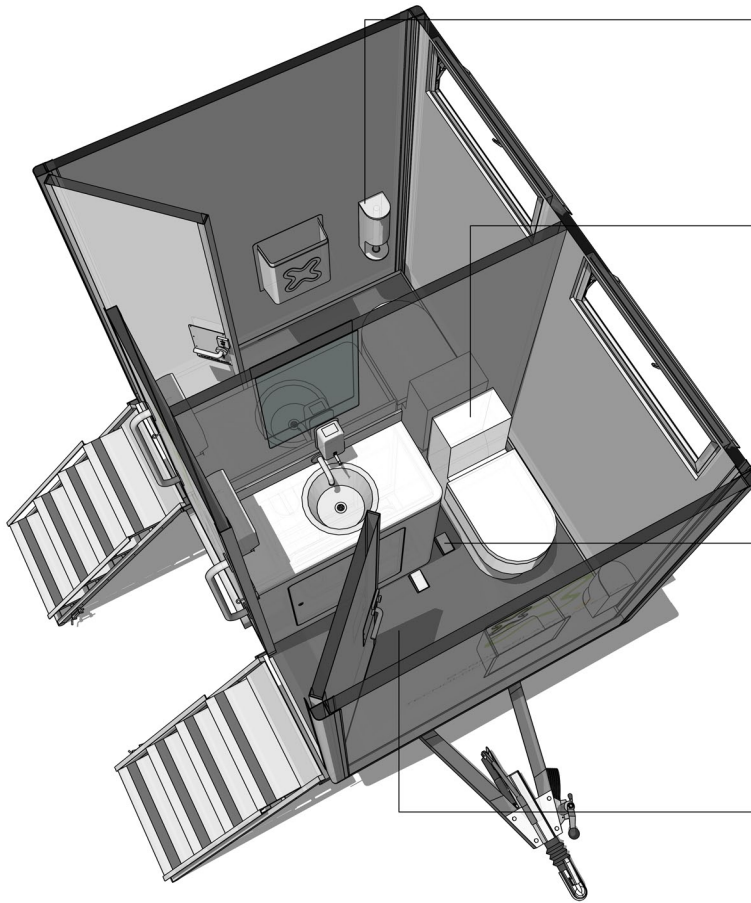

fixtures

WOSHBOX units are equipped with high quality stainless steel fixtures inside and out. Paper towel dispensers and bins close to the doors keep the unit neat and hygienic.

cistern

WOSHBOX uses state of the art toilet cisterns. Each cistern contains separate components for recycling and freshwater operation- providing operational flexibility. Custom designed float switches provide exceptionally efficient electrical usage and rapid cistern refilling. This purpose built equipment delivers high reliability and is unique to WOSHBOX.

foot switches

Hands free design - people do not like to touch public toilets so we have reduced the need to do this where possible. The toilets and hand basins are operated with waterproof IP67 rated foot switches. The waterproof switches allows for the washing down of the WOSHBOX interior.

floor

It is quick and easy to clean the WOSHBOX floor on site. It is designed to drain spillage away from the compartments and has a tray below allowing easy on-site servicing with low water usage. The floor will remain looking cleaner for longer, even under heavy usage.

windows

Aluminium framed opaque windows allow for good ventilation and daytime lighting of the WOSHBOX.

chemistry

Various chemical regimes can be used in the system including all standard portable toilet mixtures of sufficient strength. Organic enzyme based mixtures may also be used, providing the biology can cope with the volume of usage. WOSHBOX works most efficiently with J&J chemicals which are formaldehyde free, chemically stable, long-lasting, tolerant of temperature fluctuations and readily biodegrades into natural elements which are harmless to the environment.

efficient dosing

The chemical dosing system injects 50ml of fresh chemicals into the cistern per flush ensuring that the water and chemical mixture remains blue and pleasant-smelling. The cost effective WOSHBOX system prevents wasteful overdosing of chemicals and does away with premature decay of the chemical compounds while being more eco-friendly.

filter

The unique WOSHBOX high volume stainless steel filter draws water from just below the surface. The filter is quick coupled for easy removal and incorporates an integrated backwash circuit, allowing efficient high volume duty cycles and low water use.

